

## GENERAL SPECIFICATIONS \*

• L.O.A	10,77m	35'4"
• Hull length	9,96m	32'8"
• L.W.L.	9,50m	31'2"
• Beam	3,57m	11'9"
• Deep draft (Cast iron)	2,00m	6'7"
• Deep ballast weight	1 580kg	3,482 lbs
• Shallow draft (Cast iron)	1,50m	4'11"
• Shallow ballast weight	1 860kg	4,099 lbs
• Performance draft (Hydraulic retractable keel)	1,25 - 2,550m	4'1" - 8'4"
• Ballast weight performance	1 506kg	3,319 lbs
• Air draft (all masts), with aerial	15,57m	51'1"
• Light displacement	5 470kg	12,046 lbs
• Fuel capacity (standard)	130L	34 US Gal
• Fresh water capacity:		
- standard	231L	61 US Gal
- Option	130L	34 US Gal
• Engine power		
- standard	21 HP	21 HP
- Option	30 HP	30 HP

## ARCHITECTS / DESIGNERS

- Naval Architect: Marc Lombard
- Outside & interior design: Nauta Design

## EC CERTIFICATION \*

- Category A - 6 people
- Category B - 8 people
- Category C - 10 people

## STANDARD SAILS DIMENSIONS \*

• Classic mainsail (standard)	31,00m <sup>2</sup>	334 sq ft
• Furling mainsail (Option)	26,00m <sup>2</sup>	280 sq ft
• Self-tacking jib (standard)	18,30m <sup>2</sup>	197 sq ft
• Furling genoa (106 %)	26,10m <sup>2</sup>	281 sq ft
• Code 0	40,00m <sup>2</sup>	430 sq ft
• Asymmetric spinnaker	80,00m <sup>2</sup>	861 sq ft
• Classical mast:		
- I	12,82m	42'1"
- J	3,65m	12'
- P	12,66m	41'6"
- E	4,15m	13'7"
• Roller furling mast:		
- I	12,79m	42'
- J	3,65m	12'
- P	12,56m	41'2"
- E	4,50m	14'9"

## PERFORMANCE SAILS (Requires standard classical mast)

• Square top mainsail	34,70m <sup>2</sup>	373 sq ft
• Genoa (on Flatdeck furler)	27m <sup>2</sup>	290 sq ft

\* Provisional specifications, boat in process of certification.

## STANDARD EQUIPMENT

### CONSTRUCTION

- Design in accordance with European Directive requirements and according to CE certification
- Monolithic hull design in polyester
- Monolithic structural inner moulding bonded to the hull
- Fibreglass and balsa wood sandwich contact deck, with diamond pattern non-slip coating
- Hull-deck joint screwed, bonded and trimmed with 1 bulwark
- Cast iron keel fixed with bolts and stainless steel backing plates
- 2 Underhung rudders with stainless steel stock
- White coloured hull - Grey metal hull graphics

### DECK EQUIPMENT

#### RIGGING

- Standard mast  $\frac{9}{10}$  anodized aluminum deck stepped, 2 aft-swept spreaders - Without backstay
- Anodised aluminum boom
- Discontinuous stainless steel standing rigging
- Rigid boom vang with tackle
- Self-tacking jib rigging with on-deck furler
- Mainsail stay rope on the roof (with 2 chainplates)
- 1 Self-tacking jib track with traveller
- Complete running rigging: Mainsail halyard, Genoa halyard with cleat on mast, Boom topping lift with cleat on mast, Mainsheet, 1 Self-tacking jib sheet
- 8 Clutches
- 2 Flag halyards

#### WINCHES

- 1 Self-tailing winch (H35.2 STA) to port, on the roof
- 1 Aluminum "Speed Grip" winch handle
- 1 Winch handle box

### SAILS

- Classic Dacron mainsail with Natural UV protection, cross cut, semi full batten
- Self-tacking jib Dacron with UV protection Natural, horizontal cut
- Lazy jacks

### MOORING LINES - MOORING

- Self-draining chain locker - Clench bolt - Hatch cover
- Single stem roller
- 6 Aluminum mooring cleats - Stainless steel chafing plate

### SAFETY ON DECK

- Stainless steel pulpit 2 sections
- 2 Stainless steel pushpits
- 1 Lifebuoy support bracket
- Double guard lines and stainless steel stanchions
- Welded ring on pushpit for flag
- Emergency ladder on pushpit

### COCKPIT

- Self-draining cockpit
- 1 Cockpit locker under port side bench
- 2 Lockers in cockpit bottom
- Side helm's seats (aft helm seats in trim)
- 1 Liferaft locker to aft of cockpit (Usable dimensions: 800mm x 505mm x 370mm / 2'7" x 1'8" x 1'3")
- Natural solid wood slatted cockpit benches (1,56m x 0,50m / 5'1" x 1'8")
- Polyester drop-leaf cockpit table, Stainless steel handrail
- Tilling positon: Stainless steel steering wheels - 800mm diameter / 2'7" - Leather covered - Steering gear at the helm station - Steering line transmission system - Stainless steel handrail - 1 Cup holder
- 1 Steering compass to starboard of the companionway
- 2 Deck access points to tiller system
- 1 Emergency tiller
- Engine throttle and control panel on starboard
- 2 Hinged PMMA companionway doors - Sliding hatch made of PMMA
- 1 Fixed, telescopic stainless steel swimming ladder

### SWIM PLATFORM / AFT TRANSOM (in trim level)

- Fully opening transom, convertible to bathing platform (2,35m x 0,70m / 7'9" x 2'4")
- Manual opening using hoist, assisted by 2 pull cylinders
- Teak decking on swim deck
- 1 Fixed, telescopic stainless steel swimming ladder



## INTERIOR

- Alpi walnut woodwork
- Rovere Alevé type laminated floorboards
- Beige padding upholstery: Saloon & Cabins
- Néo 05 fabric interior upholstery
- Mattresses in the cabins, HR35kg/m3 foam

### Standard version: 2 cabins + 1 head

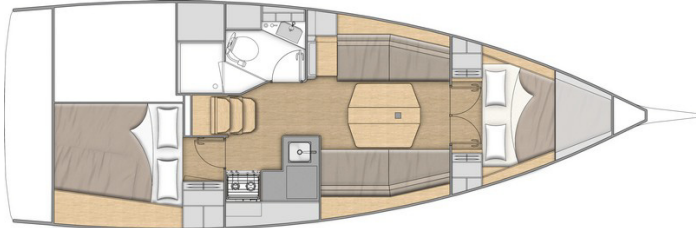

### COMPANIONWAY

Headroom: 1,89m / 6'2"

- GRP saloon companionway coated with non-slip surface on the steps
- 2 Stainless steel handrails covered with anthracite leather

### SALOON

Headroom: 1,90 - 1,85m / 6'3" - 6'1"

- 2 Lengthways saloon bench sets, can be used as a single berth: an extension cushion for the port side bench seat is stowed against the bulkhead under the chart table
- Saloon table with 2 drop-leaves and 2 central top-access storage spaces. For the retractable keel version, the dimensions of the table are larger to accommodate the keel raising system
- Storage under bench seats
- 2 LED ceiling lights
- 1 USB socket on the 12V electrical panel
- 2 Panoramic roof windows
- 2 Hull portholes with curtain
- 1 Flush deck hatch with fan, T44, blind and mosquito net

### STARBOARD GALLEY

L-shaped galley - To starboard

Headroom: 1,85m / 6'1"

- Worktop in compact Clay with painted wooden fiddles
- 1 1 rectangular stainless steel sink (320mm x 300mm / 1'1" x 1')
- 1 Mixer tap with hot/cold water under pressure
- 1 Gas cooker 2 burners - Stainless steel oven on gimbal - Stainless steel protection handrail
- Cool box 100 L / 26 US Gal top opening (Positive cold)
- Storage and lockers
- 1 Dual compartment slide-out bin (2 x 15L / 2 x 4 US Gal)
- 1 230 V socket (in trim level)
- 1 Opening porthole on coaming in the side window with mosquito net

### PORT SIDE CHART TABLE

Headroom: 1,85m / 6'1"

- Chart table with folding tray against the starboard bulkhead with shelves fitted with fiddles in the upper part
- 12 V electrical panel nearby
- 1 Adjustable LED spotlight
- 1 230 V socket (in trim level)
- 1 Single USB socket
- 1 Fixed coaming window with pleated blind

### OWNER'S CABIN

Headroom: 1,86m / 6'1"

- 1 Central double bed (2,02m x 1,60m - 0,55m / 6'8" x 5'3" - 1'10")
- 2 Hanging closets with 1 open shelf on top, open lockers along the hull
- 2 Adjustable LED spotlights in the headboard
- 1 dual USB port outlet on each side of the bed (in trim level)
- 1 230 V socket (in trim level) - to port
- 1 Flush deck hatch with fan, T44, blind and mosquito net
- 2 Hull portholes with curtain
- Double door

### STARBOARD AFT CABIN

Headroom: 1,80m / 5'11"

- 1 Double bed (2,00m x 1,60m x 1,30m / 6'7" x 5'3" x 4'3")
- 1 Hanging closet with 1 open shelf on the top
- 1 Bed access sideboard
- 2 Adjustable LED spotlights in the headboard
- 1 dual USB port (in trim level)
- 1 230 V socket (in trim level)
- 1 Opening porthole below cockpit seat with curtain (Mosquito net in trim level)

### AFT PORT SIDE HEAD

Access through saloon

Headroom: 1,92m / 6'4"

- Shower with plexiglass door - Self-draining storage bin - 1 Mixer tap - White polyester shower base
- 1 Manual toilet
- 1 80 L / 21 US Gal rigid holding tank
- 1 Polyester basin - 1 Hot/cold water mixer tap
- 1 Cabinet
- 1 Mirror
- Toilet accessories
- 1 Opening porthole in coaming
- 2 LED ceiling lights
- 1 230 V socket (in trim level, except for 3 cabins 1 head version)

### 3 cabins 1 head version (Option)

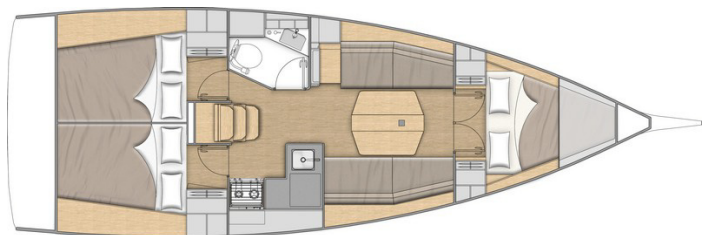

The head has a shower function mixer tap (no 230 V socket in trim level)

### 2 SYMMETRICAL AFT CABINS

Headroom: 1,80m / 5'11"

- 1 Double bed (2,00m x 1,40m x 1,13m / 6'7" x 4'7" x 3'8")
- 1 Hanging closet with 1 open shelf on the top
- 1 Bed access sideboard
- 2 Adjustable LED spotlights in the headboard
- 1 dual USB port (in trim level)
- 1 230 V socket (in trim level)
- 1 Opening porthole below cockpit seat with curtain (Mosquito net in trim level)

## ENGINE

---

- Engine Yanmar Diesel (Propeller shaft):
  - 21 CV/HP (standard)
  - 29 CV/HP (Option)
- Engine control - Control panel in cockpit (To starboard)
- Engine compartment: Soundproofing foam - Ventilation: 2 Air intakes and 1 powered air expulsion
- 1 Alternator (12V / 125Ah)
- 1 Rotomoulded diesel tank 130 L / 34 US Gal (below aft starboard cabin berth) - Gauge on electrical panel - 1 Deck filler
- Filters: Seawater - Diesel - Water separator
- Stainless steel shaft line
- Fixed three blades propeller
- 1 Engine access through companionway (opening with 2 gas struts)
- 2 Access to side engine: Head & Aft cabin

## ELECTRICITY

---

- 12V circuit
- 1 AGM service battery (75Ah) - 1 AGM engine battery (50Ah)
- 1 Power distributor
- 12 V electrical panel (Fuses - Voltmeter - 1 Fuel gauge)
- 1 Single USB socket at chart table
- LED lighting: Overhead lights, Adjustable spotlight in cabins & at chart table
- LED navigation lights: 1 Masthead light - 1 Engine navigation light - 1 Anchor light on masthead

## PLUMBING

---

- 1 Rotomoulded freshwater tank 206 L / 54 US Gal, under berth in forward cabin
- Electrical gauge on 12 V panel
- 1 Deck filler
- Pressurised electric water pump - Expansion tank - Inline filter
- 25 L / 7 US Gal Electric water heater (engine use) below saloon starboard bench
- 1 80 L / 21 US Gal rigid holding tank
- 1 Electric bilge pump - 1 Manual bilge pump
- 1 Electric shower drain pump

## GAS

---

- Gas cylinder locker - starboard aft cockpit
- Regulator and safety tap
- Gas leak detector

## MISCELLANEOUS ITEMS

---

- Smoke detector



## TRIM LEVEL & PACKS

### TRIM LEVEL

	CONFORT	FAMILY
<ul style="list-style-type: none"> <li>• Teak slatted aft platform</li> <li>• Helm seats, slatted teak</li> <li>• 1 Halyard bag (to port)</li> <li>• Hot/cold water cockpit shower</li> <li>• Galley: Compact sink cover with cutting board</li> <li>• Hifi Fusion + Interior loudspeakers &amp; Waterproof exterior speakers</li> <li>• Dual USB socket: in the saloon (x 1), in the forward cabin (x 2), in the aft cabins (x1)</li> <li>• Full 230 V system (6 Inside sockets, 1 Shore power socket)</li> <li>• 40 Amperes battery charger</li> <li>• 2 AGM service batteries - 100Ah (in lieu of standard - 75Ah)</li> <li>• Mosquito nets for opening portholes</li> <li>• Saloon: LED indirect lighting</li> <li>• Galley: Stainless steel 2 burner oven/grill cooker on gimbal (in lieu of standard)</li> </ul>	<ul style="list-style-type: none"> <li>▪</li> <li>▪</li> <li>▪</li> <li>▪</li> <li>▪</li> <li>▪</li> <li>▪</li> <li>▪</li> <li>▪</li> <li>▪</li> <li>▪</li> <li>▪</li> <li>▪</li> <li>▪</li> </ul>	<ul style="list-style-type: none"> <li>▪</li> <li>▪</li> <li>▪</li> <li>▪</li> <li>▪</li> <li>▪</li> <li>▪</li> <li>▪</li> <li>▪</li> <li>▪</li> <li>▪</li> <li>▪</li> <li>▪</li> <li>▪</li> <li>▪</li> </ul>
<ul style="list-style-type: none"> <li>• 1 000 W Electric windlass + Remote control</li> <li>• Aft transom protection</li> <li>• Bow stainless steel protection</li> <li>• "Luxe" polyester drop-leaf cockpit table</li> <li>• Outboard engine bracket</li> <li>• Additional fresh water tank (130L / 53 US Gal)</li> <li>• Galley: Sea water foot pump with cool box draining function</li> <li>• Saloon &amp; Cabins: Ventilators</li> </ul>		<ul style="list-style-type: none"> <li>▪</li> <li>▪</li> <li>▪</li> <li>▪</li> <li>▪</li> <li>▪</li> <li>▪</li> <li>▪</li> <li>▪</li> </ul>

### ELECTRONICS PACKS: B&G

	COASTAL	OFFSHORE
<ul style="list-style-type: none"> <li>• To starboard: 1 Triton<sup>2</sup> Graphic display</li> <li>• Sensor (Log, Speedometer, Temperature)</li> <li>• Wind Sensor (Windvane, Anemometer)</li> <li>• Windex Windvane</li> </ul>	<ul style="list-style-type: none"> <li>▪</li> <li>▪</li> <li>▪</li> <li>▪</li> </ul>	<ul style="list-style-type: none"> <li>▪</li> <li>▪</li> <li>▪</li> <li>▪</li> </ul>
<ul style="list-style-type: none"> <li>• Starboard helmstation: 1 Multifunction touchscreen Zeus 7" wide wireless (GPS, Chart plotter, Card reader - Navionics Silver cartography included) - <i>The Triton display moves to the port side</i></li> <li>• NAC3 autopilot + control (to port)</li> <li>• V60 VHF radio fixed to the chart table + AIS receiver function</li> </ul>		<ul style="list-style-type: none"> <li>▪</li> <li>▪</li> <li>▪</li> </ul>

### RIGGING PACKS (Incompatible with First Line Pack)

	DOWNWIND	UPWIND	DOWNWIND + UPWIND
<ul style="list-style-type: none"> <li>• 1 Starboard manual (H35.2 STA) rigging winch + Cadet Grey halyard bag</li> <li>• Polyester bowsprit with integrated anchoring gear and bobstay (for Code 0 and asymmetric spinnaker)</li> <li>• Asymmetrical spinnaker rigging / Code 0 (sheets, Blocks, Halyards)</li> <li>• Additional jammers (on the roof for the halyard or on the coaming for the Genoa sheet, depending on the pack)</li> <li>• Rigging run back to cockpit (except boom topping lift)</li> <li>• 2 Manual (H40.2 STA) genoa sheet winches + Aluminum "Speed Grip" winch handle + Winch handle box</li> <li>• Genoa sheet 3D adjustment rings on the roof (replacing the self-tacking jib track and the traveller)</li> <li>• Genoa sheet on furler, high resistance Dacron (to replace the standard self-tacking jib)</li> </ul>	<ul style="list-style-type: none"> <li>▪</li> <li>▪</li> <li>▪</li> <li>▪</li> <li>▪</li> <li>▪</li> <li>▪</li> </ul> <p>1 Triple jammer, on starboard roof</p>	<ul style="list-style-type: none"> <li>▪</li> <li>▪</li> <li>▪</li> <li>▪</li> <li>▪</li> <li>▪</li> <li>▪</li> </ul> <p>2 Double jammers, in coaming (1 to port, 1 To starboard)</p>	<ul style="list-style-type: none"> <li>▪</li> <li>▪</li> <li>▪</li> <li>▪</li> <li>▪</li> <li>▪</li> <li>▪</li> </ul> <p>2 Double jammers, in coaming + 1 Single clutch, on the coachroof</p>

### IN-MAST FURLER PACK

- The standard Dacron self-tacking jib is retained.
- Anodised aluminium <sup>9</sup>/<sub>10</sub>th in-mast furler, 2 sets of spreader bars
  - Dacron cross-cut mainsail





## PERFORMANCE PACK

### FIRST LINE ALU PACK (incompatible with the rigging packs)

Requires standard classic mast and a trim level

Boast supplied without sail - Performance sails optional

- Polyester bowsprit with integrated anchoring gear and bobstay (for Code 0 and asymmetric spinnaker)
- Flatdeck genoa furler
- Additional jammers: 1 Double jammer on coaming to port and starboard for mainsail sheet, genoa sheet, adjustment of Genoa sheet traveller (control line) + 1 Triple jammer on the roof for spinnaker halyard/code 0
- Performance, Punch, Dyneema core running rigging (Halyards: Mainsail, Genoa, Code 0, Asymmetric spinnaker)
- Genoa sheet 3D adjustment rings on the roof
- Asymmetrical spinnaker rigging / Code 0 (sheets, Blocks, Halyards)
- German system (Two-way mainsheet at the helm station)
- 1 Starboard manual (H35.2 STA) rigging winch + Cadet Grey halyard bag
- 2 Manual (H40.2 STA) genoa sheet winches + Aluminum "Speed Grip" winch handle + Winch handle box
- Performance hull decoration (Red sticker)

## OPTIONS

### HULL - DECK - COCKPIT

- Pearl grey gel-coat
- Slatted teak cockpit floor
- Synthetic covering for bottom of cockpit (flexible, removable covering with press stud attachment, imitation teak slats)
- "Luxe" polyester/wood cockpit table, Stainless steel handrail, 1 Waterproof USB socket for charging smartphone or using LED lighting (lighting not supplied), Central storage (15L / 4 US Gal), Cup holders - requires Confort trim level
- Cover for "Luxe" cockpit table (Cadet Grey)
- Steering wheels covers (Cadet Grey)
- "Luxe" coachroof sprayhood (Cadet Grey)
- "Luxe" bimini (Cadet Grey)
- Cockpit seats Dolce 51
- 12 V tunnel bow thruster (Side Power) + Dedicated batteries and charger (50Ah - 12V)
- 2 Mooring cleats on transom
- 3 folding blades propeller
- Mooring kit:
  - Delta 16 kg/32 lbs anchor (galvanized steel)
  - Chain (Diameter: 10mm /  $\frac{3}{8}$ " - Length: 28m / 92')
  - Line (Diameter: 18mm /  $\frac{11}{16}$ " - Length: 40m / 131')
  - 6 Fenders - M (Diameter: 200mm / 8" - Length: 635mm / 2'1")
  - 4 Moorings lines (Diameter: 16mm /  $\frac{5}{8}$ " - Length: 12m / 39'4")
- Electric windlass (1 000 W) - Remote control (not compatible with Family trim level)
- Windlass control in cockpit with chain counter
- Access openings to port and starboard
- Outboard engine bracket (not compatible with Family trim level)
- Shore fresh water supply
- Stand + support plates on the hull (option required for grounding the retractable keel version)
- Opening porthole on the cockpit coaming + Mosquito screens in the aft cabins

## B&G ELECTRONIC

- WR10 Wireless autopilot remote control
- AIS 500

## RIGGING - SAILS

- Performance sail pack (implies pack First Line Alu): High resistance Dacron square-topped mainsail, 4 battens, Natural UV protection, cross cut + Genoa sheet on Flatdeck furler, high resistance Dacron, Natural UV protection, cross cut
- Code 0 on furler for mast with in-mast furling or standard mast - Mylar Taffetas (implies pack Downwind or First Line pack)
- Natural colour Lazy bag
- Self-tacking jib rigging (track and traveller) - implies pack Upwind or Upwind & Downwind pack

## WINCHES

- 1 Port electric primary winch (H35.2 STAEH), in lieu of standard

## INTERIOR EQUIPMENT

### LAYOUT VERSIONS

- 2 cabins 1 head version
- 3 cabins 1 head version

### AMBIANCE

- Interior woodwork: Alpi white oak
- Brown oak laminated floors (only with Alpi white oak woodwork)
- Interior upholstery according to colour chart
- Macadamia padding upholstery: Saloon & Cabins
- Companionway steps made from mixed wood on floor

### ON BOARD COMFORT EQUIPMENT

- Sea water foot pump, in galley (with cool box drainage function)
- Additional fresh water tank (130L / 34 US Gal) below aft port side cabin bed
- Grey water recovery tanks (130L / 34 US Gal) for sailing in inland waters - Not compatible with additional water tank
- 16 000 BTU air conditioning full boat (only for use via shore power supply) - Not compatible with 3 cabin version
- 8 000 BTU air conditioning saloon and front cabin (only for use via shore power supply)
- 8 000 BTU Autonomous air conditioning on Lithium battery in forward cabin and saloon, operating duration: 3 hours on battery, useful when at anchor. + recharging and use of motor or shore power - (12V - 230V) (Not compatible with heating, inverter, lithium battery options - required Confort or Family trim level)
  - Included:
    - 1 Dedicated 12 V/230 V - 2 000 W inverter (this inverter does not allow the onboard comfort options)
    - 3 Lithium batteries (90Ah)
    - 1 60 Ah service battery charger (replacing the 40 Ah charger for the trim level)
    - Navicolor 3.5" screen for displaying the battery charge level
- Forced air heating fuel
- 1 12V / 230V inverter - 2 000 W
- Quiet Flush seawater electric toilet
- Shore fresh water supply
- 1 90 Ah lithium battery replacing the 2 AGM100 Ah service batteries (requires trim level). The engine battery is still AGM + Navicolor 3.5" screen for displaying the battery charge level