

Glorious

**Sunseeker Predator
2006**



Glorious

SUNSEEKER PREDATOR 72



LOA: 22.26M (73'03 FT) | BEAM: 5.34M (17'52FT) | DRAFT: 1.65M (5'41 FT)

BUILT: 2006 / REF 2017 | SHIPYARD: SUNSEEKER UK | GUESTS: 6+2 | CABINS: 3 | CREW: 2 | SPEED: 22 KNOTS



Glorious

Sunseeker Predator 72 - Glorious is Croatian flagged high performance luxury charter yacht built by Sunseeker UK launched in 2006 as Predator 72 model. Since her delivery she is kept in immaculate condition by her owner. In 2017, she went to a major refit during which she was upgraded inside out Her exterior styling is by Sunseeker in house designers with navaL architecture by Don Shead. She boasts fantastic sunbathing areas on her stern and fore deck, AL-fresco table, BBQ and hydraulic swimming platform. Her light and airy salon offers a comfy seating area with the coffee table and the hard top that converts whole area into an open space flooding her salon with the light when open.

She sleeps up to six plus two charter guests in three air conditioned cabins with one berth next to galley. Full beam master cab offers a queen sized bed, en-suite with the shower and seating area, while her VIP cabin offers a queen sized bed and smaller en-suite with the shower. Double cabin offers double berth and en-suite shower. She is equipped with the following audio-visual gear: LCD TV's, SAT TV Bose sound system, DVD, WiFi internet via 3G/4G router which is subject to the signal

Glorious



Glorious



Glorious



Glorious



Glorious



Glorious



Glorious



Glorious



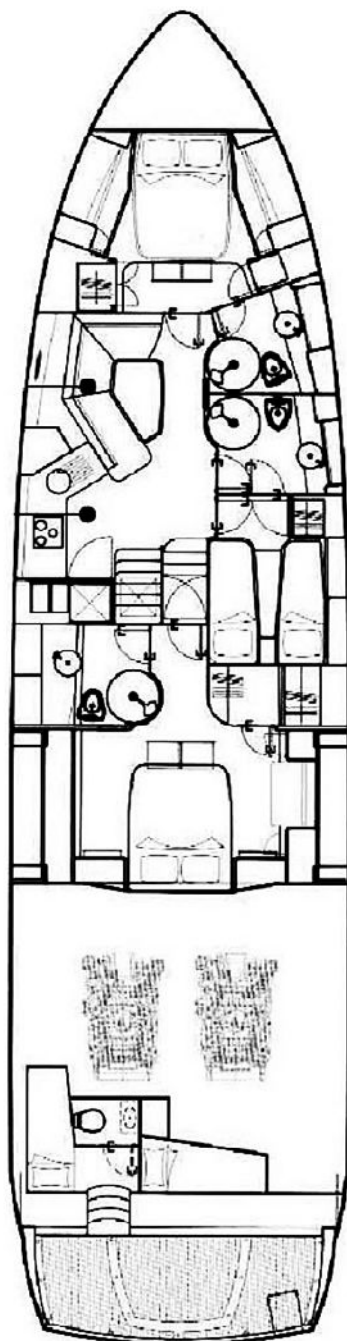

TEHNICAL SPECIFICATIONS

LOA: 22.26m (73'03 ft)
Beam: 5.34m (17'52 ft)
Draft: 1.65m (5'41 ft)
Built: 2006
Refitted: 2017
Flag: Croatian
Builder: Sunseeker UK
Naval architect: Don Shead/Sunseeker
Exterior design: Sunseeker In House
Interior design: Sunseeker In House
Type: Planing motor yacht
Classification: CSR
GT: 69 T
Hull: GRP
Superstructure: GRP
Engines: 2x 1550 BHP - MAN CRM
Generator: 1 x 13 kW Kohler
Fuel consumption: 350 Liters/Hr
Fuel capacity: 3.900 liters
Fresh water capacity: 720 liters
Bow thruster: Yes
Stern thruster: Yes
Air condition: Yes
Top speed: 36.0 knots
Cruising speed: 22.0 knots
Range: 240 NM @ 22.0 Knots cruise speed
Cabins: 3 (3 x double)
Guests: 6+2
Crew: 2



TENDER AND SEA TOYS

- 1 x Williams 325 Jet Tender with 80 BHP engine
- 1 x Jet Ski Sea Doo GTX with 185 BHP engine
- Doughnut
- Water skis
- Jobe Flyer
- Snorkeling gear
- Hydraulic swimming platform
- Underwater lights



www.masteryachting.com/megayacht-charter

office@masteryachting.com