

A Cloudy Bay

**Sunseeker Manhattan 73
2012**



A Cloudy Bay

SUNSEEKER MANHATTAN 73



LOA: 22.60M (74' 2") | BEAM: 5.73M (18' 10") | DRAFT: 1.6M (5' 4")

BUILT: 2012 | SHIPYARD: SUNSEEKER | GUESTS: 9 | CABINS: 4 | CREW: 2 | SPEED: 22 KNOTS



A Cloudy Bay

'Cloudy Bay' is the only Manhattan 73 on the market fitted with the bigger MTU engines. She is also fitted with an impressive list of extras, including hard top, two generators, fin stabilizers, x2 JMS, water maker, SAT TV, Bose system, etc. The interior is a one off, unique design. The black American walnut satin finish with wenge timber planks flooring in the saloon, dining and helm area highlight the sophistication of the yacht's interior. 'Cloudy Bay' has been a family boat and always maintained to a great standard by the captain and crew.

The boat has 4 beautiful cabins for 8 guests and with additional crew cabin for 2. Owners master cabin has the full beam layout and is located amidship. The rest of the accommodation comprise of forward VIP cabin, a double Guest Cabin to starboard and twin Guest cabin on the port side.

'Cloudy Bay' is an extremely well-equipped yacht, with features including Apple universal iPod docks connected with the televisions in all of the cabins, a Bose entertainment surround Soundsystem fitted all throughout the yacht, dimmer switches on all interior lighting, electric BBQ grill on the flybridge, Samsung 55" television in the saloon, and much more. Berthed in Marina Trogir, 'Cloudy Bay' is located just 10 minutes away from Split airport.

A Cloudy Bay



A Cloudy Bay



A Cloudy Bay



A Cloudy Bay



A Cloudy Bay



A Cloudy Bay



A Cloudy Bay



A Cloudy Bay



A Cloudy Bay



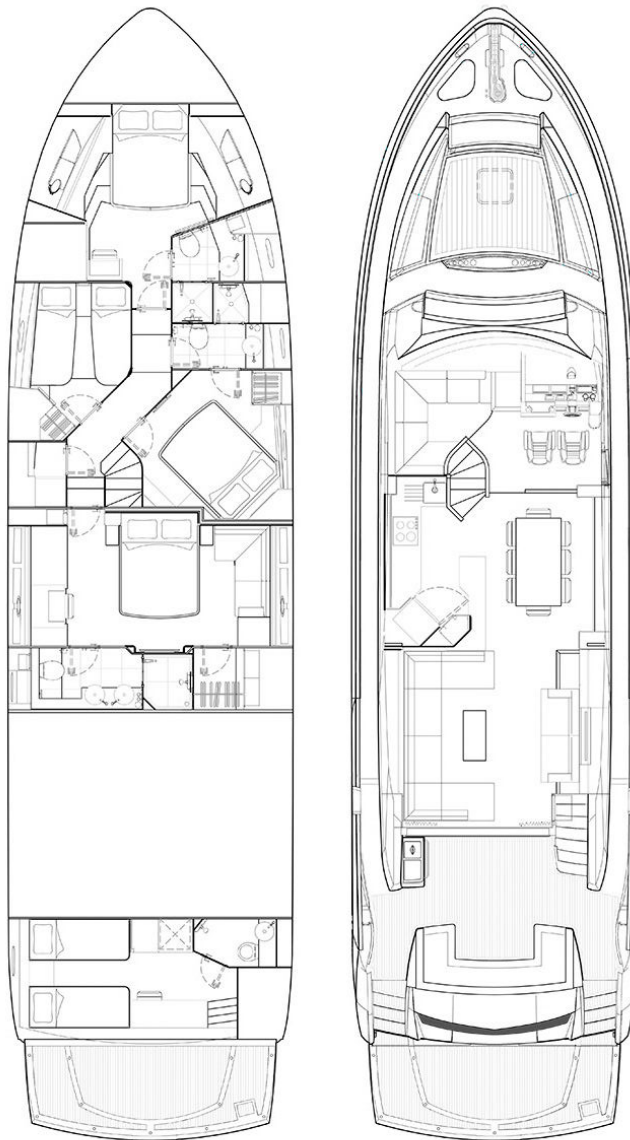

TEHNIICAL SPECIFICATIONS

Length: 22.60 metres (74' 2")

Beam: 5.73 metres (18' 10")

Draft: 1.6 metres (5' 4")

Built: 2012

Builder: Sunseeker

Hull Construction: GRP

Hull Configuration: Planing hull

Cabins: 3 Double, 1 Twin (3 Double, 2 Single)

Engines: MTU 12V 2000 M94 1622hp

Cruising Speed: 22 knots

Fuel Consumption: 330 Litres/Hr

Two **generators**

Fin **stabilizers**

JMS x2

Water maker

Guests: 9

Crew: 2



TENDER AND SEA TOYS

- Tenders + Toys AVON 4.5 RB with 70HP
- WATER SKIS
- WAKEBOARD
- TOWABLE RINGO
- LAZY LAGOON
- 2 x SEABOB WITH FAST CHARGE



www.masteryachting.com/megayacht-charter

office@masteryachting.com